

TQ-95

CERAMIC HEATER DUAL POWER CAP INCLUDED

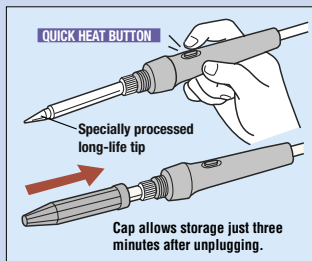

●2 stage heat switching system. ●Pulling the trigger boosts the output of normal position (Low) by 10 times. ●The pistol grip was designed through careful ergonomics research. It can be operated for extended periods comfortably even by someone with a small hand. The design allows full concentration on the work by making it easy to see the tip.

Model	TQ-95
Voltage	110-130V, 220V AC 50/60Hz
Power Consumption	High 150W / Low 15W (110-130V model) High 200W / Low 20W (220-240V model)
Length	210mm (w/o cord bushing)
Weight	65g (w/o cord)

Replacement Parts

- TQ-95 Heater
- TQ-95H
- TQ-95 Spacer
- TQ-77SS
- TQ-95 Collar
- TQ-77NUT
- Heater Barrel
- TQ-77HP (L) 220-240V
- TQ-77HP (S) 100-130V
- TQ-95 Heat Insulation Cap
- TQ-CAP

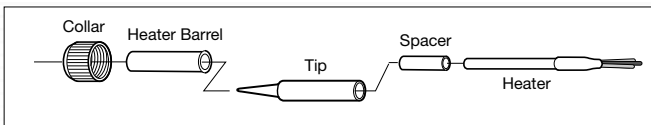

Replacement Tips () Size 65mm=for 220-240V AC model

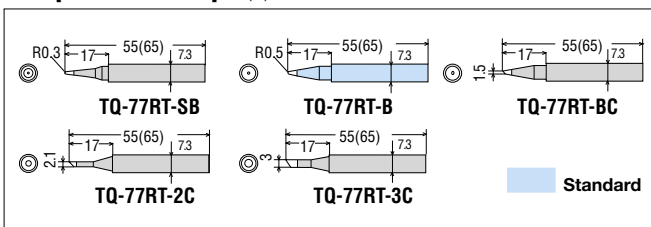

TQ-77

CERAMIC HEATER DUAL POWER



●2 stage heat switching system. ●Pulling the trigger boosts the output of normal position (Low) by 10 times. ●The pistol grip was designed through careful ergonomics research. It can be operated for extended periods comfortably even by someone with a small hand. The design allows full concentration on the work by making it easy to see the tip.

Model	TQ-77
Voltage	110-130V, 220-240V AC 50/60Hz
Power Consumption	High 150W / Low 15W (110-130V model) High 200W / Low 20W (220-240V model)
Length	167mm (w/o cord bushing)
Weight	90g (w/o cord)

Replacement Parts

- TQ-77 Heater
- TQ-77H
- TQ-77 Spacer
- TQ-77SS
- TQ-77 Collar
- TQ-77NUT
- Heater Barrel
- TQ-77HP (L) 220-240V
- TQ-77HP (S) 110-130V

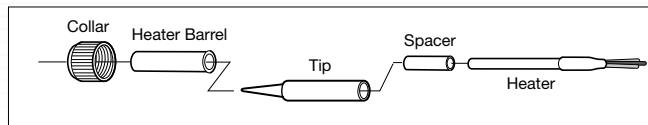

Replacement Tips () Size 65mm=for 220-240V AC model

